



MOON  
DOG  
WORLD

FUNCTION  
PACK

MOON DOG  
FUNCTIONS & BREWERY TOURS (approx. 500)  
BAR: ENJOY@MOONDOG.COM.AU

MOON DOG LAGER \$4.95	TOO MUCH CREAM \$4.95	TRIPLE LIPS \$4.95	SHRIMP & CHILI \$14.95
OLD MATE \$4.95	SMOOTHIE \$4.95	COOL SMOOTHIE \$4.95	SHRIMP & CHILI \$14.95
ROCK CHAI \$4.95	SMOOTHIE \$4.95	TOP HALF PINE \$4.95	SHRIMP & CHILI \$14.95
PACK DADDY \$4.95	SMOOTHIE \$4.95	SMOOTHIE \$4.95	SHRIMP & CHILI \$14.95
CAKE WALK \$4.95	SMOOTHIE \$4.95	SMOOTHIE \$4.95	SHRIMP & CHILI \$14.95
SLICE W/ BEAN \$4.95	SMOOTHIE \$4.95	SMOOTHIE \$4.95	SHRIMP & CHILI \$14.95



Moon Dog World in Preston boasts an impressive 72 beer taps, a waterfall, lagoon, beer garden, playground, elevated sun decks and hidden pinball and games room.

There is truly something here for everyone!

Our venue has four different semi-private function spaces to choose from, that can host 20 to 100 guests. We can help you celebrate birthdays, milestone events, corporate gatherings, engagement parties, laid back receptions, the options are endless!

We welcome function enquiries of any kind and handle each one on a case by case basis so please get in touch!

**OUR  
FUNCTION  
SPACES**

# FULL TOP DECK

70-100 people

The Top Deck is our largest function area and is great for work parties and larger celebrations. It overlooks the entire venue and has options for both stand up socialising and more intimate seated events. It's accessible from either end of the area via staircases.

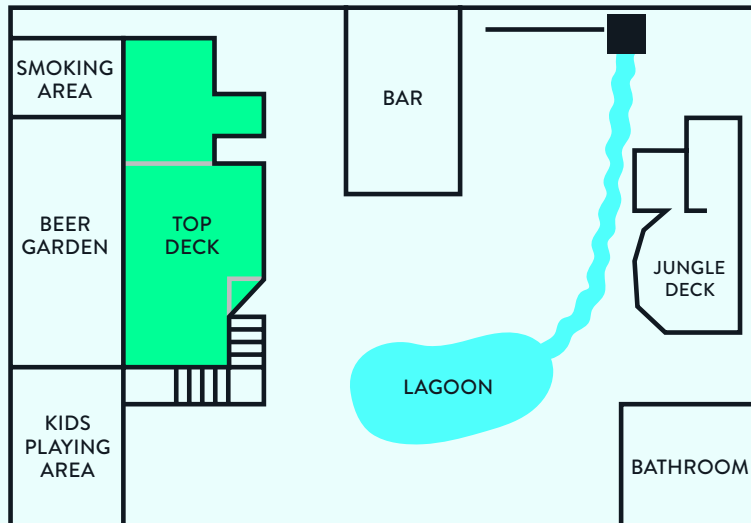

# HALF TOP DECK

30-60 people

The Half Top Deck is perfect for those medium sized functions with the option of standing or seated service. It overlooks the lagoon and huge brewery windows. The Half Top Deck has its own private staircase entrance.

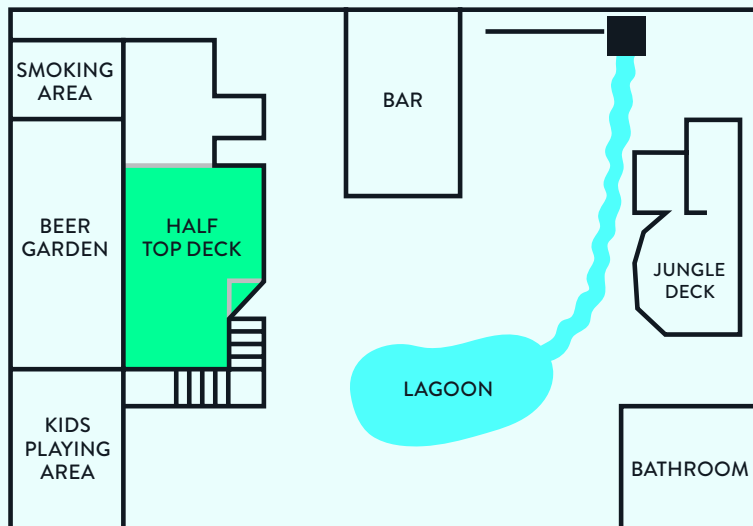

# TOP DECK BOOTHS

20-40 people

The Top Deck Booths include two large diner style booths for a more intimate setting, as well as a handful of smaller tables overlooking the bar. This area boasts a 70-inch screen for presentations or slideshows and you have your own private staircase leading up to the area.

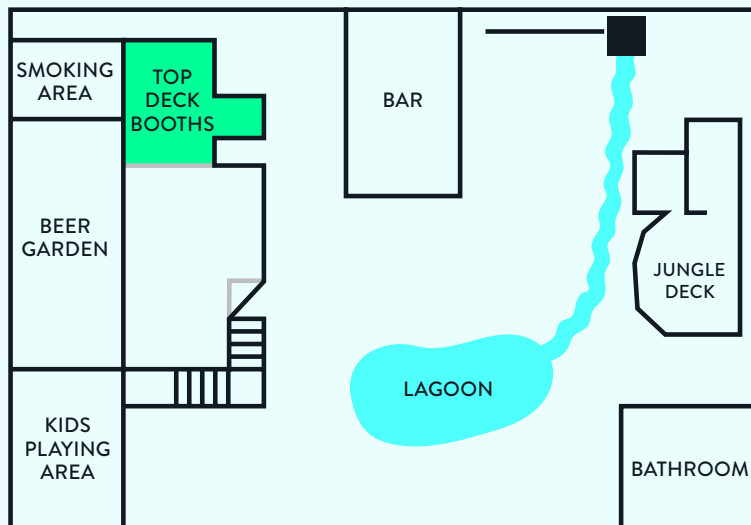

# JUNGLE DECK

20–30 people

The Jungle deck is your birdseye view over Moon Dog World and the lagoon. You're surrounded by plants on your own private deck! On Friday and Saturday nights the bottom section of the Jungle Deck is allocated to DJs which makes this the perfect VIP party area, but on weekdays the whole area is bookable which means we can accommodate slightly larger groups!

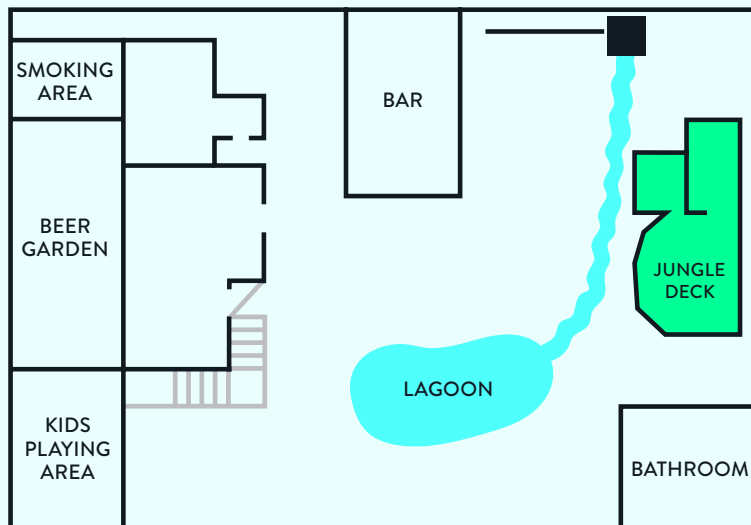

# LARGE CONTAINER

20–50 people

The Large Container makes a great home base for your group. It has two booths, stool seating on the counters and the possibility to spill out onto the main bar area with the addition of barrels. It's also right next to the bar!

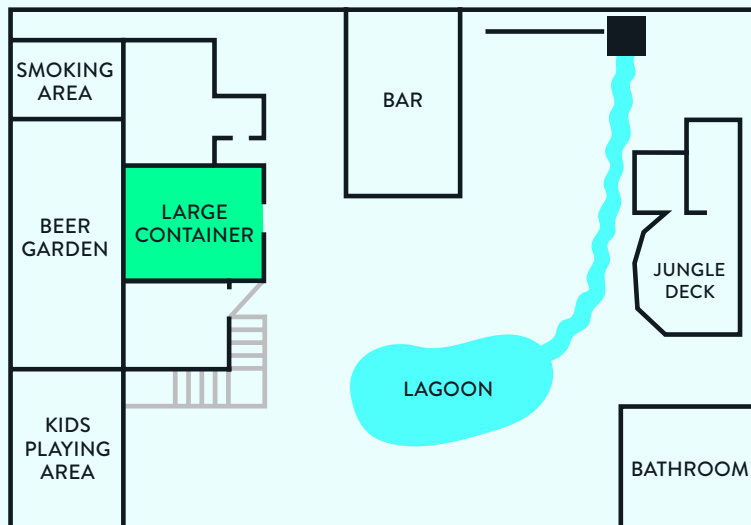



**OUR  
FUNCTION  
PACKAGES**

# CANAPES

**Per Person Packages**

**Minimum 20 people**

**Option 1 Hungry**

(2 Smaller Bites + 2 Bigger Bites) \$29 pp

**Option 2 Famished**

(2 Smaller Bites + 3 Bigger Bites) \$38 pp

**Option 3 Starving**

(3 Smaller Bites + 3 Bigger Bites) \$44 pp

**Option 4 All Out!**

(4 Smaller Bites + 4 Bigger Bites) \$58 pp

Add a sweet bite for \$5 pp

**Individually Priced Items**

**Minimum order of 20 each**

**Smaller Bites** \$6 each

**Bigger Bites** \$9 each

**Sweet Bites** \$6 each



# CANAPES MENU

## Smaller Bites

### Haloumi bites

Honey, almond and hazelnut dukkah (v, gf)

### Mac and cheese spring rolls (v)

### Pork and fennel sausage rolls

### Roasted vegetable sausage rolls (vg)

### Chunky steak and ale pies

### Braised lentil and root vegetable pies (vg)

### Pulled chicken mini hard-shell taco

Tomatillo, frijoles, salsa,  
sour cream (gfo)

### BBQ pulled jackfruit mini hard-shell taco

Frijoles, salsa, sour cream (v, gfo, vgo)

## Bigger Bites

### Crispy chicken ribs

Spicy mayo, celery (gfo)

### Sweet chipotle cauliflower bites

Spicy mayo, pickles (vg, gfo)

### Beef slider

Tomato, lettuce, pickles,  
burger sauce (gfo)

### Vegan slider

Tomato, lettuce, pickles,  
burger sauce (vg, gf)

### Crispy chicken slider

Creamy slaw, BBQ sauce, mayo

### Pulled shiitake mushroom soft taco

Apple slaw, coriander (vg, gf)

### Pulled pork soft taco

Apple slaw, coriander (gf)

## Sweet Bites

### Classic vanilla slice

Flaky puff pastry,  
vanilla custard (v)

### Chocolate brownie

Chocolate cream (v, gf)

### Coconut sago pudding cups

Passionfruit, ginger crumb (vg, gf)

\*Our menus change seasonally; substitutions may be made.

(gf) gluten free (gfo) gluten free optional (v) vegetarian (vg) vegan (vgo) vegan optional

# SEATED SHARING MENU

Prefer a sit-down meal? We offer a sharing menu perfect for long lunches and special dinners. Sharing menu functions are served family style and are located on our main floor on long tables, perfect for groups of 20–80 people.

## Sharing Menu Packages Minimum 20 people

**Entrees / Mains / Sides \$60 pp**

**Mains / Sides / Desserts \$60 pp**

**Entrees / Mains / Sides / Desserts \$70 pp**



# SEATED SHARING SAMPLE MENU

## Starters

**Mixed olives**  
(gf, vg)

**Avocado Hummus,**  
pico di gallo, dukkah,  
tortilla chips (gf, vg)

**Smoked Salmon,**  
pomegranate and  
pistachio salsa (gf)

## Mains

**Chilli and Lime  
Roasted Whole Chicken,**  
roquette, charred lime (gf)

**Slow Roasted  
Lamb Shoulder,**  
red chimichurri (gf)

**Roasted Pumpkin,**  
yellow mole, green tomato  
and endive salad (gf, vg)

## Sides

**Green Oak Leaf Salad,**  
cucumber, radish,  
lemon and dill dressing  
(gf, vg)

**Garlic Roasted  
Kipfler Potatoes,**  
sea salt (gf, vg)

## Sweet

**Chocolate Brownie,**  
peanut butter  
whipped cream (gf, v)

**Mini Vanilla Slice,**  
vanilla custard in  
flaky pastry (v)

\*Our menus change seasonally; substitutions may be made.  
(gf) gluten free (gfo) gluten free optional (v) vegetarian (vg) vegan (vgo) vegan optional

# DRINKS

Our bar is stocked with all your Moon Dog favourites along with a range of other drink options. Beverages can be purchased as a bar tab (normal bar prices per drink) or as a beverage package (set price per person).

## Basic Package

4 core range Moon Dog beers, cider, Fizzer Alcoholic Seltzer, house wine, soft drink

3 hours – \$58

4 hours – \$73

## Mid-Tier Package

All core range Moon Dog beers, cider, Fizzer Alcoholic Seltzer, house wine, soft drink

3 hours – \$68

4 hours – \$83

## Premium Package

All core range Moon Dog beers, 2 seasonal Moon Dog beers, cider, Fizzer Alcoholic Seltzer, all wine by glass, basic spirits, soft drink

3 hours – \$85

4 hours – \$100

## Add ons

Drink on arrival – Arrange a cocktail or glass of bubbles to greet your guests on arrival (price dependent on drink).

Shot tray – A selection of signature Moon Dog shots, \$11 per shot / minimum 20 shots.

Private waitstaff – \$55 per staff / per hour.

# SOME ANSWERS TO YOUR QUESTIONS!

## **How long is my function?**

Functions are a standard 4 hours, but you are more than welcome to extend your function if there is availability.

## **Is my space private?**

Our spaces are semi-private and are a part of our whole venue. That means your space is reserved just for you, but you'll be using the same bar, bathroom facilities, etc as the rest of the venue.

## **What's the music situation?**

### **Can I play my own music?**

As our function spaces are semi-private and part of the whole venue, we are unable to play separate music for functions.

This also means we cannot have outside entertainers (such as clowns, magicians, etc).

We play music that appeals to everyone and have DJs every Friday and Saturday night!

## **Do you have alcohol other than beer?**

Of course we do! Our bar is stocked with our Fizzer seltzers, wines, and spirits and non-alcoholic beverages.

## **Can kids come?**

Children are more than welcome to attend our venue! All children under the age of 18 must be accompanied by a parent, guardian, or responsible adult.

Persons under the age of 18 are asked to leave the venue at 11pm.

## **How much does a function cost?**

Costs depend on the space, day and length you would like to book. Get in touch to discuss!



**Want to find out more?**  
Get in touch with our Functions Coordinator!  
[functions@moondogbrewing.com.au](mailto:functions@moondogbrewing.com.au)  
(03) 9428 2307